

S500 Temperature & Humidity Data Logger

Introduction

S500 temperature and humidity data logger is **features** large LCD display, elegant appearance and high precision. All the sensors are produced in Switzerland, which assures duality and stability. External and internal sensors are available to fit customers' specialized need.

S500-TH



S500-TH-RJ45



Standard Accessories



Optional Accessories



Technical Specifications

Resolution	Temperature: 0.1°C / Humidity: 0.1%RH
Power supply	9V block battery, optional DC9-12V adapter
Display	LCD display
Dimension	135mm x 124mm x 35mm (5.31" x 4.88" x 1.37" inch)
LCD size	88mm x 55mm (3.4 " x 2.17" inch)
Weight	380g
Accessories	PC-Software, data cable, 9V block battery, screw, use manual, AC-DC adapter
Interface	RS485/RJ45/RS232/USB

Model List

USB interface type	S500-TH	S500-EX	S520-TH	S520-EX	S580-TH	S580-EX	S500-EX+	S500-EX++
RJ45 interface (Ethernet) model	S500-TH-RJ45	S500-EX-RJ45	S520-TH-RJ45	S520-EX-RJ45	S580-TH-RJ45	S580-EX-RJ45	S500-EX+-RJ45	S500-EX++-RJ45
Temperature Accuracy	±0.5°C	±0.5°C	±0.3°C	±0.3°C	±0.2°C	±0.2°C	±0.5°C	±0.5°C
Humidity Accuracy	±5%RH	±5%RH	±3%RH	±3%RH	±2%RH	±2%RH	±5%RH	±5%RH
Record Volume	43000				65000		43000	
Sensor type	Internal	External	Internal	External	Internal	External	External	External
Temperature Measurement Range	-20~70°C	-40~85°C	-20~70°C	-40~85°C	-20~70°C	-40~85°C	-40~120°C	-40~180°C
Humidity Measurement Range	0~100%RH							

Applications

It has been widely applied in agricultural research, food industry, medical industry, electrical industry, environmental protection and laboratories.



S500-ET



S520-DT



Standard Accessories

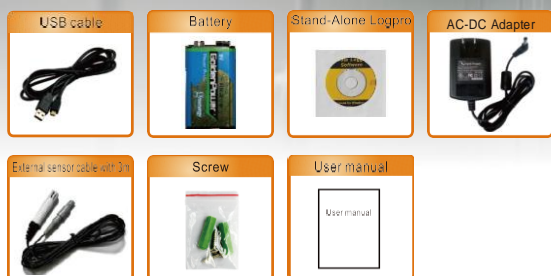

Optional Accessories



Technical Specifications

Resolution	Temperature: 0.1°C
Power supply	9V battery, optional DC 9-12V adapter
Display	LCD display
Dimension	135mm×124mm×35mm(5.31"×4.88"×1.37"inch)
LCD size	88mm×55mm(3.46"×2.17"inch)
Weight	380g
Accessories	PC-Software, data cable, 9V block battery, screw, use manual, AC-DC adapter.
Interface	RS485/RJ45/RS232/USB
Alarm	Will be triggered when data value exceeds limits

Features:

- Original sensors imported from Switzerland.
- Records 4,300 readings.
- Large screen displays temperature, humidity, number of groups data stored, and time simultaneously.
- Easy to operate; can be placed on desk or mounted on wall.
- Built-in sound and light alarm.



EMC
EN 61326-1
EN 6132-2-2

Model List

Model	S500-ET	S500-DT	S500-EPT	S500-DPT	S520-ET	S520-DT	S520-EPT	S520-DPT
Temperature Accuracy	±0.5°C	±0.5°C	±0.5°C	±0.5°C	±0.3°C	±0.3°C	±0.3°C	±0.3°C
Record Volume	43000							
Sensor type	External	External dual probe	External	External dual probe	External	External dual probe	External	External dual probe
Temperature Measurement Range	-40~85°C	-40~85°C	-100~+100°C	-100~+100°C	-40~85°C	-40~85°C	-100~+100°C	-100~+100°C

Applications

It has been widely applied in agricultural research fields, food industry, medical industry, electrical industry, environmental protection and laboratory etc.

www.huato.com



contacto@dahecinst.com

dahecinstrumentacion@gmail.com



+52 5586114372
+52 7791340470



LogPro Recorder Analysis Software

LogPro software is Huato temperature and humidity recorder dedicated data analysis software, beautiful interface, elegant, easy to use and efficient, the software is very comprehensive, can logger attribute settings, download logger data, graphically analyze data, export the data to Excel / PDF / BMP and other formats.

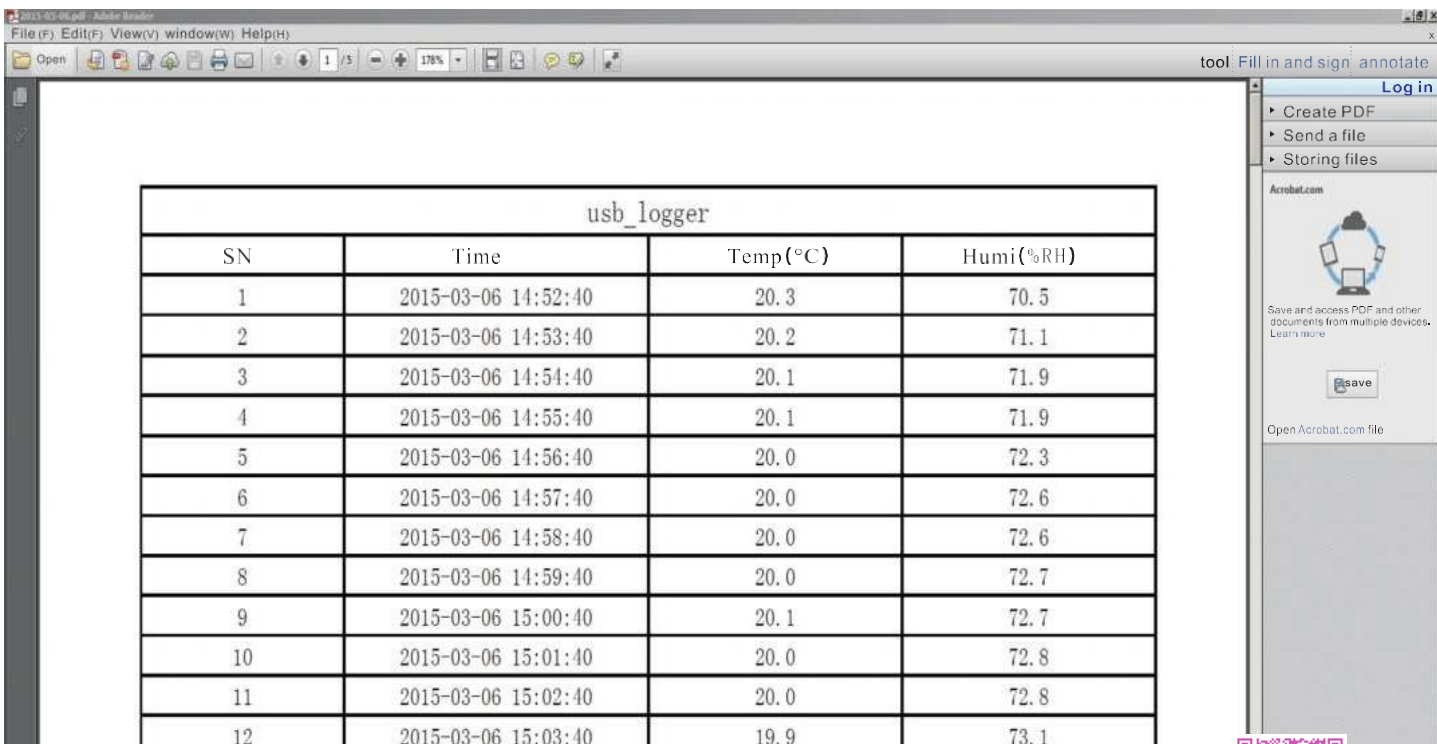
The screenshot shows a PDF viewer displaying a table of data from 'usb_logger'. The table has columns for SN, Time, Temp(°C), and Humi(%RH).

SN	Time	Temp(°C)	Humi(%RH)
1	2015-03-06 14:52:40	20.3	70.5
2	2015-03-06 14:53:40	20.2	71.1
3	2015-03-06 14:54:40	20.1	71.9
4	2015-03-06 14:55:40	20.1	71.9
5	2015-03-06 14:56:40	20.0	72.3
6	2015-03-06 14:57:40	20.0	72.6
7	2015-03-06 14:58:40	20.0	72.6
8	2015-03-06 14:59:40	20.0	72.7
9	2015-03-06 15:00:40	20.1	72.7
10	2015-03-06 15:01:40	20.0	72.8
11	2015-03-06 15:02:40	20.0	72.8
12	2015-03-06 15:03:40	19.9	73.1



Data Logger Setup

- A.System**
 - Name: Logger
 - Type: Data Logger
 - Model: S380WS
 - SN: HE2014663
 - Firmware: E1107
- B.Sampling**
 - Mode: Standby
 - Battery: Normal
 - Sampling Interval(s): 10
 - Logging Interval(s): 60
 - Downsize: Save always
- C.Storage**
 - Start Mode: No delay
 - Stop Mode: FIFO
 - Delay Time: 0
 - Logs: 525
 - Total: 129024
- D.Alarm**
 - Alarm: Off
 - LCD: On
 - Power: Normal
 - CH1 High: 70
 - CH1 Low: -20
 - CH2 High: 100
 - CH2 Low: 0
- E.Offset**
 - CH1: 0.0
 - CH2: 0.0

Ready Time: --- STANDBY --- HUATO SYSTEM CO., LTD.

TesPro V1.20 - HE2014663_20150618_0937.tesp

Records Report (HE2014663)

TOTAL LOGS:57, CHANNELS:1, BEGIN:2015-06-18 09:35:52, END:2015-06-18 09:37:44.

CHANNEL 01, C, MAX:32.8, MIN:32.1, AVE:32.4

SN	DATE	TIME	1st
1	2015-06-18	09:35:52	32.1
2	2015-06-18	09:35:54	32.8
3	2015-06-18	09:35:56	32.6
4	2015-06-18	09:35:58	32.1
5	2015-06-18	09:36:00	32.4
6	2015-06-18	09:36:02	32.5
7	2015-06-18	09:36:04	32.5
8	2015-06-18	09:36:06	32.2
9	2015-06-18	09:36:08	32.4
10	2015-06-18	09:36:10	32.1
11	2015-06-18	09:36:12	32.4
12	2015-06-18	09:36:14	32.7
13	2015-06-18	09:36:16	32.7
14	2015-06-18	09:36:18	32.4
15	2015-06-18	09:36:20	32.2
16	2015-06-18	09:36:22	32.1
17	2015-06-18	09:36:24	32.2
18	2015-06-18	09:36:26	32.5
19	2015-06-18	09:36:28	32.4
20	2015-06-18	09:36:30	32.2
21	2015-06-18	09:36:32	32.3
22	2015-06-18	09:36:34	32.3
23	2015-06-18	09:36:36	32.6
24	2015-06-18	09:36:38	32.5
25	2015-06-18	09:36:40	32.3
26	2015-06-18	09:36:42	32.6
27	2015-06-18	09:36:44	32.7
28	2015-06-18	09:36:46	32.6
29	2015-06-18	09:36:48	32.5
30	2015-06-18	09:36:50	32.4
31	2015-06-18	09:36:52	32.6
32	2015-06-18	09:36:54	32.4
33	2015-06-18	09:36:56	32.5
34	2015-06-18	09:36:58	32.6
35	2015-06-18	09:37:00	32.4
36	2015-06-18	09:37:02	32.4
37	2015-06-18	09:37:04	32.4

Ready 2015-06-18 09:35:58 32.1 C HUATO ELECTRIC CO., LTD.

TesPro V1.20 - HE2014663_20150618_0937.tesp

Records Report (HE2014663)

TOTAL LOGS:57, CHANNELS:1, BEGIN:2015-06-18 09:35:52, END:2015-06-18 09:37:44.

CHANNEL 01, C, MAX:32.8, MIN:32.1, AVE:32.4

1. Name	2. SN
HE2014663	HE2014663

3. Catalogue	4. Model	5. Hardware
Instruments	HE801	V506

1. Sampling Interval	2. Log Interval
1	2

1. Logs Count	2. MANU Logs	3. Capacity
0	5	36738

1. CH1 High Limit	2. CH1 Low Limit	3. Offset
1800	0	0

1. Upper Limit	2. Low Limit	3. Offset
1800	-200	0

1. CH3 High	2. CH3 Low	3. Offset
1800	-200	0

1. CH4 High	2. CH4 Low	3. Offset
1800	-200	0

Ready 2015-06-18 09:36:06 32.2 C HUATO ELECTRIC CO., LTD.

